

# Simple Maps – Position, Features.

## Table of Contents

Teaching Plan Overview and Summary.....	<a href="#">page 2</a>
Interpret simple maps of familiar surfaces, rooms and outdoor spaces and describe the position of objects and features.....	<a href="#">page 3</a>

### Differentiate and Assess

Not every student will be ready to investigate this concept at this Level and so we will need to differentiate to ensure every student is learning at their leading edge. Select the Differentiate button on this screen.

### Integrate

Every mathematical concept is integrally related to other mathematical concepts. Teaching and learning related concepts simultaneously develops deep relational understanding. Select the Integrate button on this screen.

### Intervene

Some students may not yet be ready to investigate this concept at any Level, and so we will need to provide some intervention. Select the Intervention button on this screen.

# SIMPLE MAPS – POSITION, FEATURES.

## EXPLICIT TEACHING PLAN OVERVIEW PAGE

THIS PAGE IS A SUMMARY OF THE EXPLICIT TEACHING PLAN, INCLUDING STRATEGIC QUESTIONS, AND DESCRIBING THE SEQUENCE WHICH WILL OCCUR OVER MULTIPLE LESSONS.

RESOURCES: SIMPLE MAPS, PENCIL, PAPER

### WHAT COULD WE DO?

Children:

- describe the position of objects on a map of familiar places, for example,

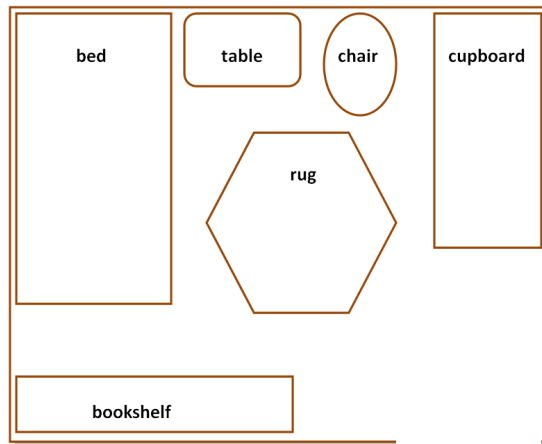
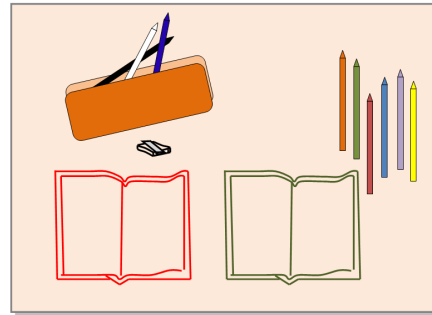

### WHAT LANGUAGE COULD WE USE TO EXPLAIN AND ASK QUESTIONS?

Children

- ask one another questions about describing the position of objects and features, for example:
  - ▶ How could we use position words to describe the position of objects on this map?
  - ▶ Where is the red book?
  - ▶ Is the red book next to the green book?
  - ▶ Is the red book below the sharpener?
  - ▶ Is the red book beneath the sharpener?
  - ▶ Is the red book to the left of the green book?
  - ▶ Where is the chair?
  - ▶ Is the chair between the table and cupboard?
  - ▶ Is the chair beside the rug?

# SIMPLE MAPS – POSITION, FEATURES.

## EXPLICIT TEACHING PLAN

FULL EXPLICIT TEACHING PLAN, EMBEDDING DEEP RELATIONAL UNDERSTANDING, METALANGUAGE, AND QUESTIONS THAT MAY BE USED OVER MULTIPLE LESSONS.

### WHAT COULD WE DO?

Children think about, talk and listen to a friend about, then have the opportunity to share what they already know.

Children discuss maps that they have seen.

Display a map of the top of a desk, [for example](#).

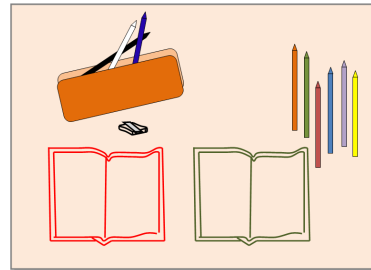

### WHAT LANGUAGE COULD WE USE TO EXPLAIN AND ASK QUESTIONS?

- ▶ Today brings an investigation about maps.
- ▶ What do you know about maps?
- ▶ Talk about maps with a friend.
- ▶ Is anyone ready to share what they are thinking about maps?
  
- ▶ What maps have you seen?
- ▶ Here is a map of a desk top.
- ▶ What objects can you see in this map of a desktop?
- ▶ Can you see pencils?
- ▶ How many pencils?
- ▶ Can you see 6 pencils on the table and 3 more pencils in the pencil case?
- ▶ Can you see books?
- ▶ How many books?
- ▶ Can you see 2 books?
- ▶ Can you see a pencil case?
- ▶ Can you see a pencil sharpener?
  
- ▶ We've been investigated using position words to describe the position of objects.

Children describe the position of the red book.

Children describe the position of the red pencil.

Display a map of a room, [for example](#),

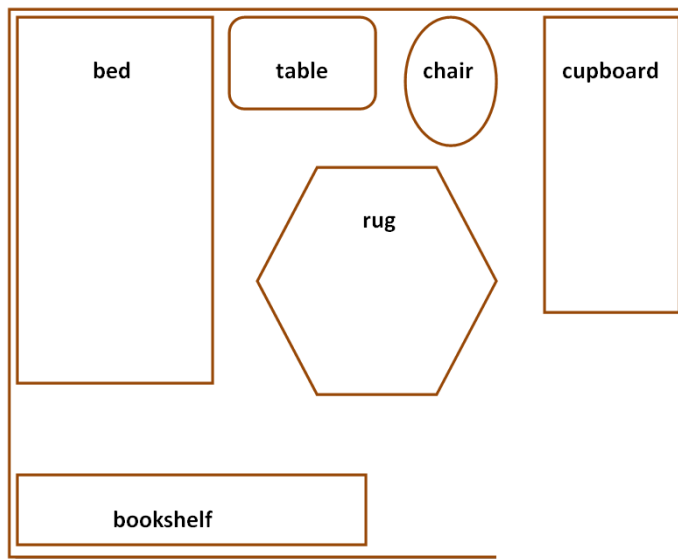

- ▶ Could we use the position words to describe the position of objects on this map?
- ▶ How could we describe the position of these objects?
- ▶ Where is the red book?
- ▶ Is the red book next to the green book?
- ▶ Is the red book below the sharpener?
- ▶ Is the red book beneath the sharpener?
- ▶ Is the red book to the left of the green book?
  
- ▶ Where is the red pencil?
- ▶ Is the red pencil next to the green pencil?
- ▶ Is the red pencil beside the green book?
- ▶ Is the red pencil on the right of the green book?
- ▶ Is the red pencil to the right of the green pencil?
  
- ▶ Here is a map of a bedroom.
- ▶ What objects can you see in this map of a bedroom?
- ▶ Can you see a chair?
- ▶ Can you see a cupboard?
- ▶ Can you see a rug?
- ▶ Can you see a bookshelf?
  
- ▶ How could we describe the position of these objects?
- ▶ Where is the rug?
- ▶ Is the rug next to the chair?

- ▶ Is the rug in front of the chair?
- ▶ Is the rug to the right of the bed?
- ▶ Is the rug in the middle of the room?
  
- ▶ Where is the chair?
- ▶ Is the chair next to the table?
- ▶ Is the chair beside the cupboard?
- ▶ Is the chair on the right of the table?
- ▶ Is the chair to the left of the cupboard?
- ▶ Is the chair between the cupboard and the table?

